

KUTSD6NV

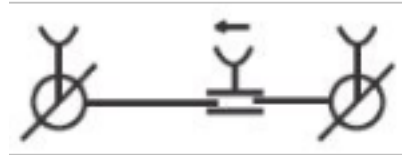
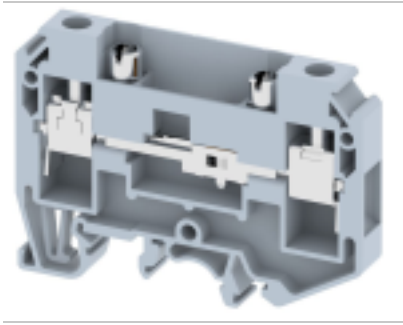

Approvals

CE

General Data

Type	KUTSD6NV
Wire Termination Technology	Screw Clamp
Ratings	800 V/41 A/6 sq mm
GTIN / Harmonize Custom Code	85389000
Standard Packing Qty (in No)	100
Country of Origin	INDIA
Screw Size	M3.5

Dimensions & Weight

Height (mm)	47
Height (inches)	1.85
Width (mm)	65.8
Width (inches)	2.59
Thickness (mm)	8
Weight For Standard Packing Qty (Kg)	2.6384

Material Data

Housing	PA 66
Clamping Material	SS
Standard Colour	Grey
Other Color Variants	Black, Blue, Green, Khakhi, Red, Yellow

Rated Conductor Size

Stranded Wire - min (sq mm)	0.5
Stranded Wire - max (sq mm)	6
Solid Wire - min (sq mm)	0.5
Solid Wire - max (sq mm)	10

Ratings - IEC

Standard	IEC 60947-7-1
Rated Voltage (V)	800
Rated Current (A)	41
Rated Cross Section (sq mm)	6
Short Time Withstand Current (kA)	0.72
Rated Impulse Withstand Voltage(kV)	8
Pollution Degree	III

Accessories

End Plate

KPSD

Height : 37.40 mm

Width : 65 mm

Thickness : 1.50 mm

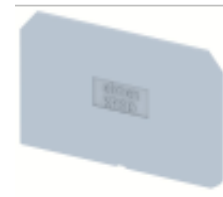

End Clamp

DCKN (Screwless - 35 mm Rail Mounted)

Height : 33 mm

Width : 43.50 mm

Thickness : 6 mm

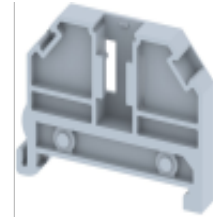

SCKN (35 mm Rail Mounted)

Height : 35.50 mm

Width : 50.60 mm

Thickness : 8 mm



SCUN (Universal Rail Mounted)

Height : 35.50 mm

Width : 50.60 mm

Thickness : 9.50 mm

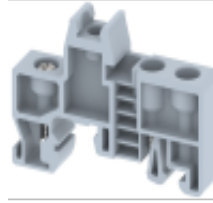

Comb-type Shorting Link

SLC6

(2W, 3W, 4W, 5W, 10W)



Marking Label

LABEL KN8

