

CURRENT TRANSFORMERS

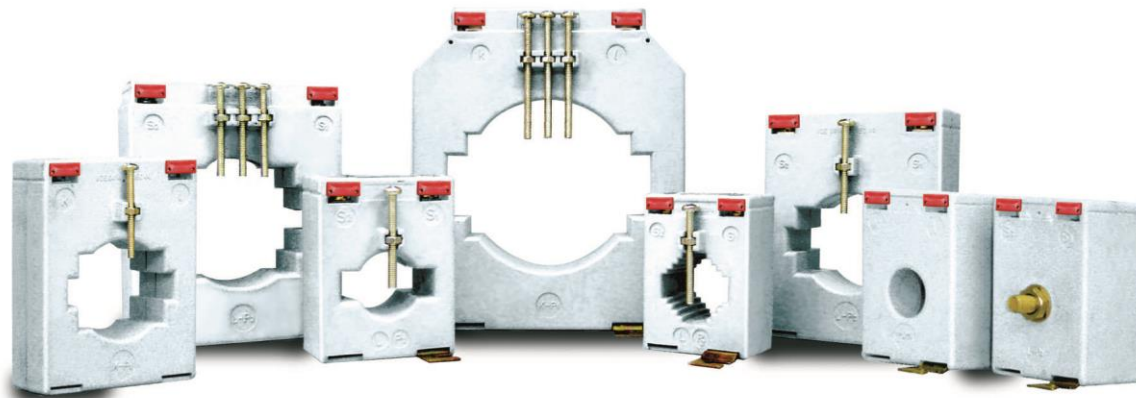

NE 201



Cable 20.4 mm

ACCURACY CLASS			
PRIMARY CURRENT	1VA	2.5VA	5VA
100	1		
150	1		
200		1	
250		1	
300		1	
400			1
500			1

NE 201

Overall DIM^M same as NE 201

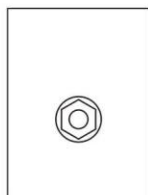

WOUND PRIMARY CT
size 78X 55X 40

ACCURACY CLASS		
PRIMARY CURRENT	2.5VA	5VA
20	1	
30	1	
40		1
50		1
60		1
75		1

NE 301

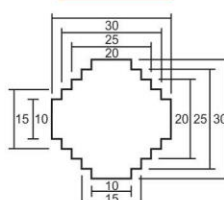

BUS BAR 30 X 10 mm

ACCURACY CLASS			
PRIMARY CURRENT	1VA	2.5VA	5VA
75	3		
80	3		
100	1		
125	1		
150	1	3	
200		1	
250		1	
300		1	
400			1

NE 401

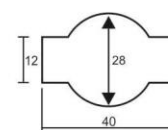

BUS BAR 40 X 12 mm

ACCURACY CLASS			
PRIMARY CURRENT	2.5VA	5VA	
150	1		
200	1		
250	1		
300	1		
400			1
500			1
600			1

NE 501

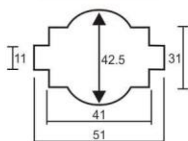

BUS BAR 51 X 11 mm

ACCURACY CLASS			
PRIMARY CURRENT	2.5VA	5VA	10VA
300	1.0		
400	1.0		
500	1.0		
600		1.0	
750		1.0	
800		1.0	
1000			1.0
1200			1.0
1250			1.0

NE 601

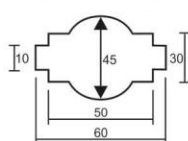

BUS BAR 60 X 10 mm

ACCURACY CLASS		
PRIMARY CURRENT	10VA	15VA
400	1	
500	1	
600	0.5	1
800	0.5	1
1000	0.5	1
1200		1
1500		1
1600		1

NE 801

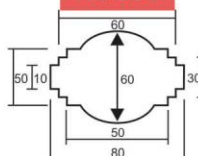

BUS BAR 80 X 10 mm

ACCURACY CLASS			
PRIMARY CURRENT	5VA	10VA	15VA
400	1		
500	1		
600	1		
800		0.5	1
1000		0.5	1
1200		0.5	1
1500		0.5	1
1600		0.5	1
2000		0.5	1

NE 1001

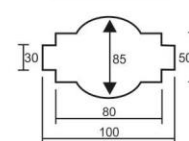

BUS BAR 100 X 30 mm

ACCURACY CLASS			
PRIMARY CURRENT	10VA	15VA	30VA
800	0.5	1	
1000		0.5	
1200		0.5	
1500		0.5	
1600		0.5	
2000		0.5	1
2500		0.5	1
3000			0.5
4000			0.5

RANGE	RATIO	WINDOW DIMENSIONS FOR BUS BAR (mm)	OVERALL DIMENSIONS H x W x TH (mm)
201	100/5A to 500/5A	20	70 x 55 x 45
301	75/5A to 400/5A	30 x 10	70 x 49 x 32
401	150/5A to 600/5A	40 x 12	78 x 60 x 32
501	300/5A to 1250/5A	51 x 11	92 x 85 x 32
601	400/5A to 1600/5A	60 x 10	108 x 85 x 32
801	400/5A to 2000/5A	80 x 10	122 x 100 x 40
1001	800/5A to 3000/5A	100 x 30	160 x 135 x 40

ACCESSORIES:

1. Mounting Brackets
2. Fixing Screw with insulated bush for window type
3. Secondary Terminal Cover
4. DIN Rail adaptor (optional)